

DO NOT SCALE. WORK TO FIGURED DIMENSIONS ONLY.
 ALL EXISTING DIMENSIONS TO BE CHECKED ON SITE.
 DRAWN ON AUTOCAD R2004 AT DEADY GAHAN ARCHITECTS LTD
 LAYERS ON THIS DRAWING COMPLY WITH BS 1192: PART 5

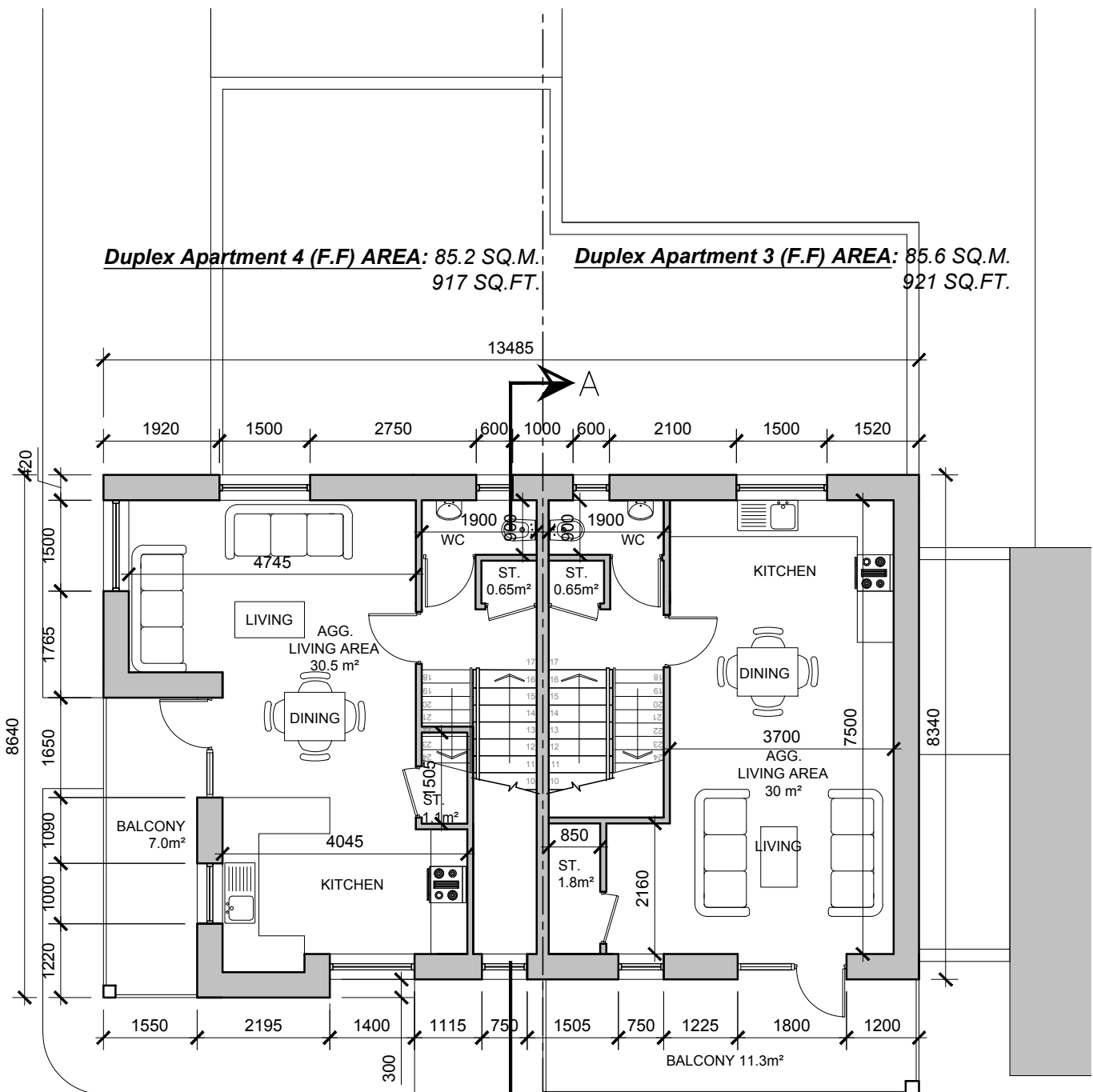

Duplex Apartment 4 (F.F) AREA: 85.2 SQ.M. / 917 SQ.FT.
Duplex Apartment 3 (F.F) AREA: 85.6 SQ.M. / 921 SQ.FT.

FIRST FLOOR PLAN
 SCALE 1:100 @ A3
 APARTMENT BLOCK F2.1/F2.2

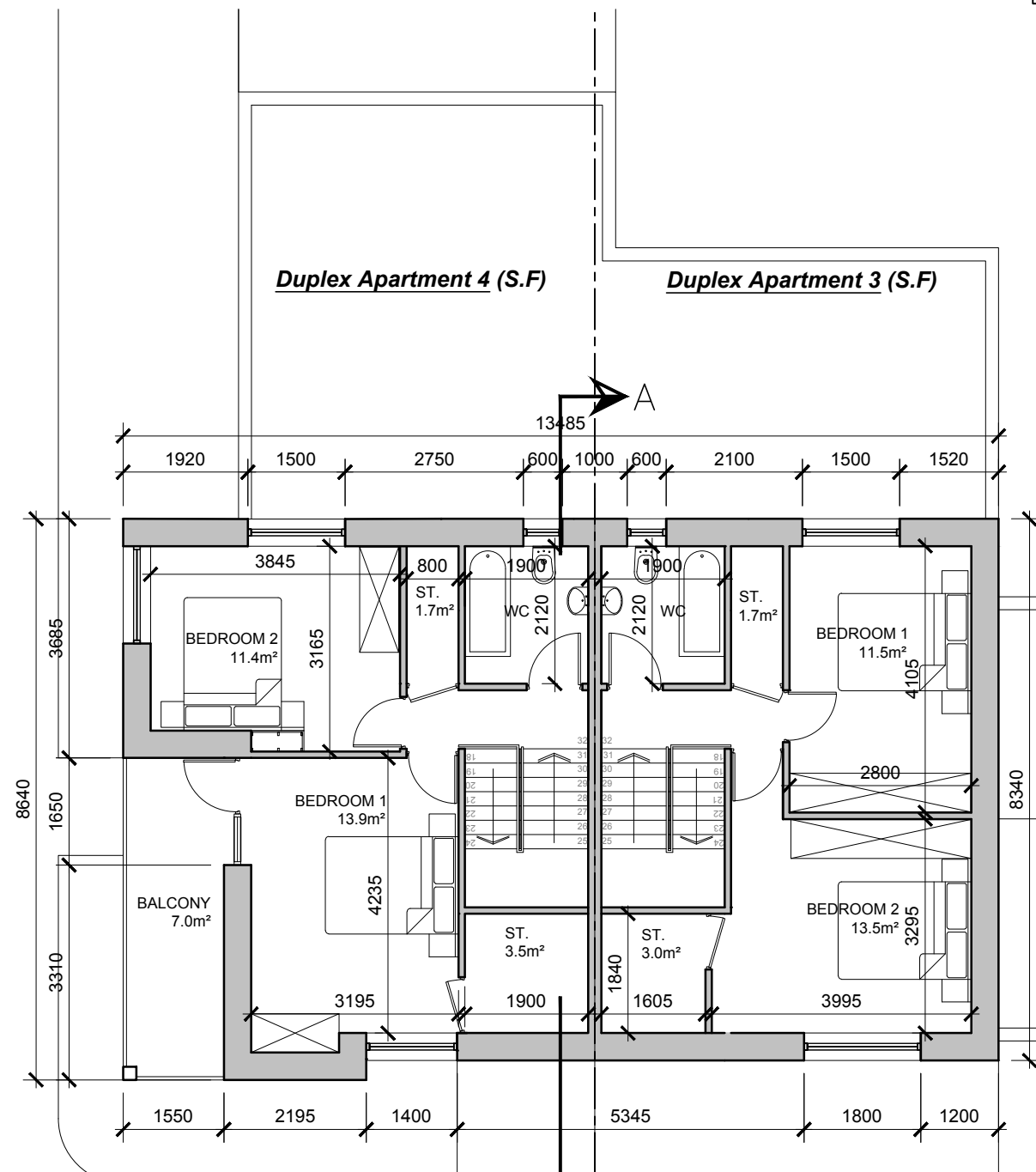

Duplex Apartment 4 (S.F) **Duplex Apartment 3 (S.F)**

SECOND FLOOR PLAN
 SCALE 1:100 @ A3
 APARTMENT BLOCK F2.1/F2.2

F2.1/F2.2_2 Bed Duplex Apartment 3	Proposed	Guidelines
Overall floor area	85.6 m ²	73m ²
Living/kitchen/dining area	30.0 m ²	30m ²
Living area width	3.7 m	3.6m
Bedroom areas	13.5m ² + 11.5m ² = 25m ²	13m ² + 11.4m ² = 24.4m ²
Storage area	7.15m ²	6m ²
Private amenity area	11.3m ²	7m ²

F2.1/F2.2_2 Bed Duplex Apartment 4	Proposed	Guidelines
Overall floor area	85.2 m ²	73m ²
Living/kitchen/dining area	30.5 m ²	30m ²
Living area width	4.7m	3.6m
Bedroom areas	13.9m ² + 11.4m ² = 25.3m ²	13m ² + 11.4m ² = 24.4m ²
Storage area	6.95m ²	6m ²
Private amenity area	14m ²	7m ²

date	rev	name	chk	note
08.06.20	P1	LG	EJG	ISSUE FOR PLANNING



Project
 PROPOSED RESIDENTIAL DEVELOPMENT
 AT BANDUFF, CORK

Drawing title DUPLEX TYPE F2.1/F2.2 FIRST & SECOND FLOOR PLANS			
Scale 1/100 @ A3	Drawn VB	Checked EJG	Date 06.02.18
Project No. 16217	Drawn No. 16217/P/607	Revision P1	
<input type="checkbox"/> Information \ Comments <input checked="" type="checkbox"/> Planning			<input type="checkbox"/> Tender <input type="checkbox"/> Construction